

# THE CITY OF NAPOLEON

## BUILDING & ZONING DEPARTMENT

255 W. RIVERVIEW

(419)592-4010

Building Permit

Page 1 of 1

Permit Number: BP2005-104

Printed: 6/28/2005

**Property Address:**

**932 Graceway Dr E.**

**Applicant** Ronald Weber  
**Address:** 6042 Rd M-4

**Approval Date:** 6/28/2005

McClure, OH 43534

**Phone:**

### Owners

**Name:** Mr. Ronald Weber  
**Address:** 6042 Rd M-4

### Contractors

#### Fees and Receipts:

Number	Description	Amount
FEE2005-513	Building Permit Fee (Auto)	\$10.00
<b>Total Fees:</b>		<b>\$10.00</b>

### Description

**Structure Use:**

**Start Date:**

**Construction Value:** \$900.00

**End Date:**

#### Floor Areas

**Living Space:**

**Other:**

**Basement/Storage:**

**Total Area:**

**Garage:**

**Description of work to be done:** 4' chain link fence

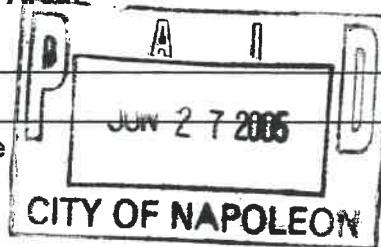

**Applicant signature:**

*Ronald Weber*

**Date:**

*6-28-05*



# PLAT OF SURVEY FOR RONALD WEBER

SURVEY OF LOT 15 IN RICHTER'S 3<sup>rd</sup> ADDITION,  
A SUB. OF OL 12 & PART OL 8, LOWE'S ADD. TO  
THE CITY OF NAPOLEON, HENRY COUNTY, OHIO

Reference Surveys

Vol. 8, Page 221

270

276

Vol. 19, Page 11

50

13

N 90° 00' E

100.7'

14

125.0'

S 0° 51' W

GRACEWAY DRIVE

50.0'

N 25° 10' 24" E  
75.8'

N 53° 34' 06" E  
75.8'

N 80° 49' 43" E

75.8'

66° 43' 33" E

15

16

17

101.2'

N 9° 36' W

19

18

110.0'

156.25'

S 90° 00' W

89.25'

89.0'

88.0'

80.0'

S 0° 51' W

A

B

A

C

34.88'

65.51'

DWG. NO. D-05420-5

DATE: JUNE 14, 2005

SCALE: 1" = 40'

SURVEY FILED IN VOLUME 31, PAGE 67

OF THE RECORD OF SURVEYS IN THE

HENRY COUNTY ENGINEERS OFFICE,

COURTHOUSE, NAPOLEON, OHIO.

## LEGEND

A - IRON PIN & CAP FOUND

B - 1" SQ. IRON PIN FOUND

C - 1/2" IRON PIPE FOUND

D - IRON PIN IN TILE & CONC. FD.

E - IRON PIN & CAP BY WESTHOVEN

F - IRON PIN & CAP SET

G - CHISELED "+" & PAINTED CONC. DRIVE

I HEREBY STATE TO THE BEST OF MY

KNOWLEDGE AND BELIEF THAT THIS

SURVEY IS CORRECT AND TRUE.

WAYNE ASICHEMEIER R. L. 5922

REGISTERED LAND SURVEYOR

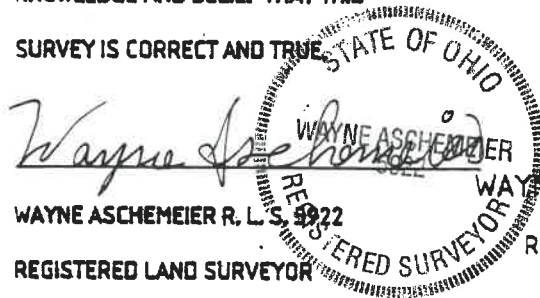

WAYNE ASICHEMEIER SURVEYING  
P. O. Box 91  
RIDGEVILLE CORNERS, OHIO 43555  
(419) 267 - 5215



# CITY OF NAPOLEON GENERAL PERMIT APPLICATION

THIS APPLICATION IS FOR RESIDENTIAL CONSTRUCTION INCLUDING BUILDING, ELECTRICAL, PLUMBING, MECHANICAL, DEMOLITIONS, REMODELING.

DATE: 6-28-05 JOB LOCATION: 932 E Graceway

OWNER: Ronald R Weber PHONE: \_\_\_\_\_

OWNER ADDRESS: 6042 RD m-4 CITY: McClune ZIP: 43534

CONTRACTOR: \_\_\_\_\_ PHONE: \_\_\_\_\_

CONTRACTOR LICENSED WITH THE CITY OF NAPOLEON?: YES: \_\_\_\_\_ NO: \_\_\_\_\_

Is any of this job going to be subcontracted out? Yes: \_\_\_\_\_ No: X

If yes to whom: \_\_\_\_\_

DESCRIPTION OF WORK TO BE PERFORMED: 4 FT CHAIN LINK fence

## PLEASE MARK THE TYPE OF WORK YOU WILL BE PERFORMING

- |   |  |
|---|--|
| <input type="checkbox"/> A/C ADD ON                 | <input type="checkbox"/> REMODELING              |
| <input type="checkbox"/> BOILER REPLACEMENT         | <input type="checkbox"/> ROOFING                 |
| <input type="checkbox"/> CURBING                    | <input type="checkbox"/> SEWER REPAIRS**         |
| <input type="checkbox"/> DECKS *                    | <input type="checkbox"/> SIDEWALK*               |
| <input type="checkbox"/> DRIVEWAY*                  | <input type="checkbox"/> SIDING                  |
| <input type="checkbox"/> ELECTRICAL SERVICE UPGRADE | <input type="checkbox"/> STORAGE SHED*           |
| <input type="checkbox"/> ELECTRICAL SERVICE NEW     | <input type="checkbox"/> SWIMMING POOL*          |
| <input checked="" type="checkbox"/> FENCE*          | <input type="checkbox"/> FURNACE REPLACEMENT     |
| <input type="checkbox"/> ADDITIONS*                 | <input type="checkbox"/> TEMP ELECTRIC           |
| <input type="checkbox"/> FURNACE NEW                | <input type="checkbox"/> WATER TAP (size _____") |
| <input type="checkbox"/> LAWN METER                 | <input type="checkbox"/> WINDOWS                 |
| <input type="checkbox"/> PLUMBING                   | <input type="checkbox"/> ZONING                  |

\*PLEASE INCLUDE A PICTURE SHOWING MEASUREMENTS FROM EXISTING STRUCTURES AND PROPERTY LINES. INDICATING THE TYPE OF WORK YOU WISH TO PERFORM.

\*\* IF WORK REQUIRES GOING INTO THE STREET A STREET BOND IS REQUIRED!

FOR PERMIT COSTS PLEASE FILL OUT REVERSE SIDE.

## PERMIT COST WORKSHEET

<u>JOB</u>	<u>BASE FEE</u>	<u>TOTAL</u>
SIDING (only) TOTAL SQ _____ X 1.00 +	\$5.00 =	\$ _____
ROOFING (only) TOTAL SQ _____ X 1.00 +	\$5.00 =	\$ _____
WINDOWS (only) # OF WINDOWS ___ X 1.00 +	\$5.00 =	\$ _____
ELECTRICAL # OF CIRCUITS _____ X 3.00 +	\$15.00 =	\$ _____
ELECTRICAL SERVICE UPGRADE	\$15.00 =	\$ _____
PLUMBING (INSIDE) repairs only	\$10.00 =	\$ _____
PLUMBING/SEWER (OUTSIDE)	\$25.00 =	\$ _____
WATER HEATER	\$5.00	\$ _____
SHED UNDER 200 SQ FT	\$ 5.00	\$ _____
FURNACE OR A/C (REPLACEMNT)	\$ 5.00	\$ _____
DEMOLITION (only)	\$30.00	\$ _____
SIDEWALK REPLACEMENT/ NEW	\$25.00	\$ _____
DRIVEWAY	\$25.00	\$ _____

ALL CONSTRUCTION, ALTERATIONS, REMODELING, SHEDS, DECKS & FENCES NOT LISTED ABOVE IS BASED ON COST OF WORK BEING PERFORMED.

COST OF WORK \$ \_\_\_\_\_ (SEE CHART) \$ \_\_\_\_\_

0.00	-	250.00	0.00	11,000.00	-	11,999.00	25.00
250.00	-	1,000.00	10.00	12,000.00	-	12,999.00	26.00
1,000.00	-	1,999.00	12.00	13,000.00	-	13,999.00	27.00
2,000.00	-	2,999.00	14.00	14,000.00	-	14,999.00	28.00
3,000.00	-	3,999.00	16.00	15,000.00	-	15,999.00	29.00
4,000.00	-	4,999.00	18.00	16,000.00	-	16,999.00	30.00
5,000.00	-	5,999.00	19.00	17,000.00	-	17,999.00	31.00
6,000.00	-	6,999.00	20.00	18,000.00	-	18,999.00	32.00
7,000.00	-	7,999.00	21.00	19,000.00	-	19,999.00	33.00
8,000.00	-	8,999.00	22.00	20,000.00	-	20,999.00	34.00
9,000.00	-	9,999.00	23.00	21,000.00	-	21,999.00	35.00
10,000.00	-	10,999.00	24.00	22,000.00	-	22,999.00	36.00
				Over 22,999	Please Call		

# City of Napoleon

## BUILDING & ZONING DEPARTMENT

255 W Riverview

(419)592-4010

F

---

### Inspection Record

Page: 1

Inspection #: INSP2005-201

Printed: 7/26/2005

---

Address: 932 Graceway Dr E.  
Napoleon, OH 43545

Reference #: BP2005-104

Applicant: Mr. Ronald Weber

Directions To Parcel:

Inspection Type: Building Final

Date: 7/21/2005

Inspector: Tom

Status: Complete

Passed?

Required Steps:

Comments:

#### Inspection Checklist:

---

#### Corrections:

Correction Code:

Date:

Correction Description:

Status:

Correction Made Date:

---

#### Conditions:

Condition Code:

Description:

Date:

Department:

Status:

---

#### Other Fields:

